



20 Westgate
Sleaford, Lincolnshire, NG34 7PN

£7,500 pa

Details



Location

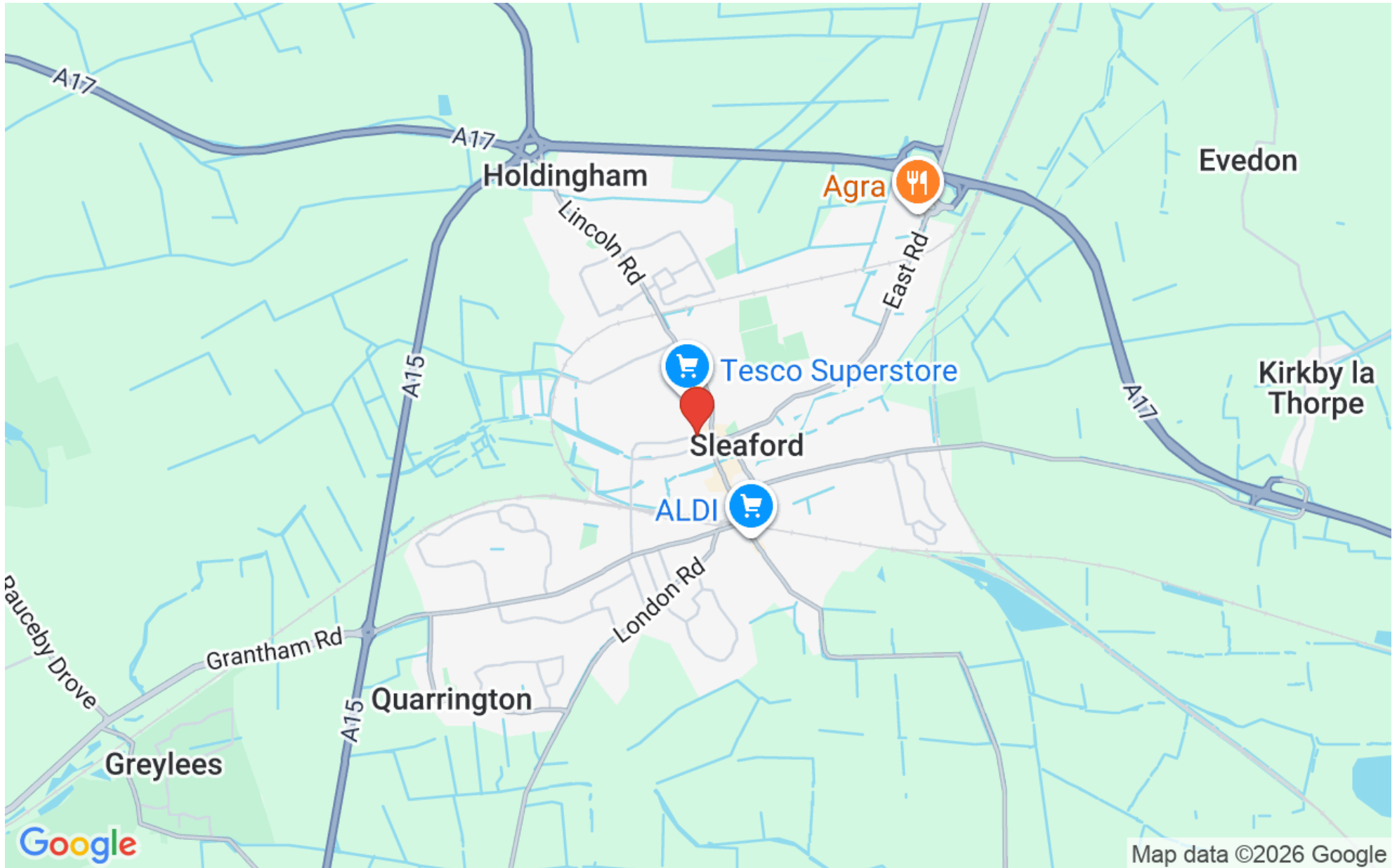

Overview



Westgate, Sleaford, NG34

Ground Floor Net Internal Area = 746 sq ft / 69.3 sq m

Outbuilding = 192 sq ft / 17.8 sq m

Total = 938 sq ft / 87.1 sq m

For identification only - Not to scale



OUTBUILDING

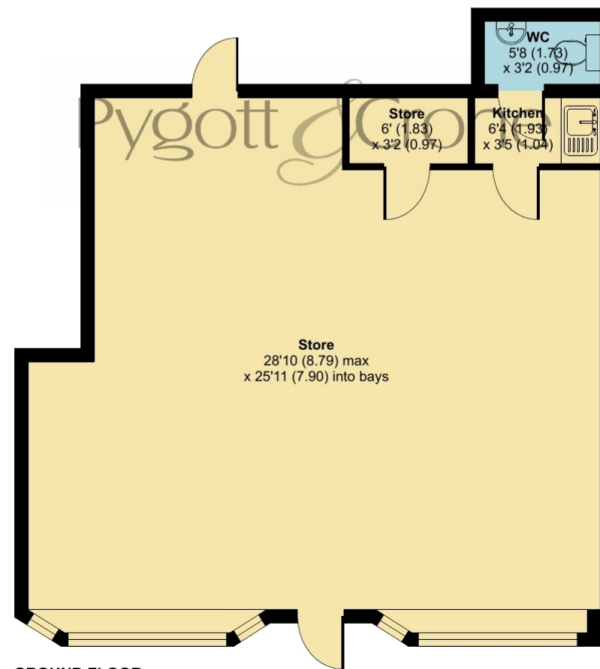

GROUND FLOOR

 Floor plan produced in accordance with RICS Property Measurement 2nd Edition, Incorporating International Property Measurement Standards (IPMS3 Commercial). © nlcocom 2026. Produced for Pygott & Crone. REF: 1462912







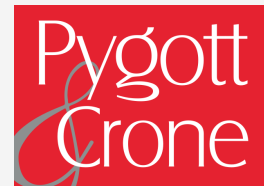

20 Westgate, Sleaford
is marketed through our Commercial office

36a Silver Street, Lincoln, LN2 1EW

0330 128 0939