



Pygott
& Crone

421a, Newark Road
North Hykeham, Lincoln, Lincolnshire, LN6 9SP

£650,000

6 Bedroom Detached House

- Freehold
- Executive Detached Family Home
- Six Bedrooms, Four Bathrooms
- Formal Dining Room, Lounge and Sun Room
- Modern Open Plan Living/Dining Kitchen with fitted units
- Balcony from Main Bedroom with views over nearby woodland
- Extended Layout
- Detached Double Garage
- Extensive lawn gardens and paved seating area
- EPC Rating - C, Council Tax Band - G

[Click here to access the Energy Performance Certificate for 421a, Newark Road, North Hykeham, Lincoln, Lincolnshire, LN6 9SP](#)



Overview

Pygott & Crone are delighted to present this impressive executive six-bedroom detached family home, occupying a highly desirable gated position set back from Newark Road. Beautifully maintained throughout, the property offers an exceptional blend of space, comfort and versatility, perfectly suited to modern family living.

The spacious accommodation is thoughtfully arranged and comprises an inviting entrance hallway, cloakroom, formal dining room, generous lounge with log burner, sun room, and a stunning open-plan living/dining kitchen fitted with a range of contemporary units. Further ground floor accommodation includes a utility room and a versatile family room, ideal for a variety of uses.



To the first floor, a striking Galleried landing provides access to four well-proportioned bedrooms and the family bathroom. The principal bedroom enjoys the added benefit of a private balcony with attractive views across nearby woodland. A further staircase rises to the second floor, where two additional bedrooms and a family shower room provide excellent accommodation for larger families or guests.

Externally, the property is accessed via a substantial private block-paved driveway, included within the property's ownership, over which the neighbouring property has a right of access. The driveway offers ample off-road parking and leads to a detached double garage. A standout feature of the home is the generous rear garden, which comprises extensive lawned areas and a paved terrace, providing an excellent setting for outdoor entertaining, relaxation, and family activities.

Situated in the ever-popular area of North Hykeham, the property enjoys a tucked-away setting whilst remaining conveniently positioned for a wide range of amenities and transport links. The city of Lincoln, North Hykeham's shopping facilities, the A46 Lincoln Bypass and the mainline railway station are all within easy reach, making this an excellent choice for both commuters and families.





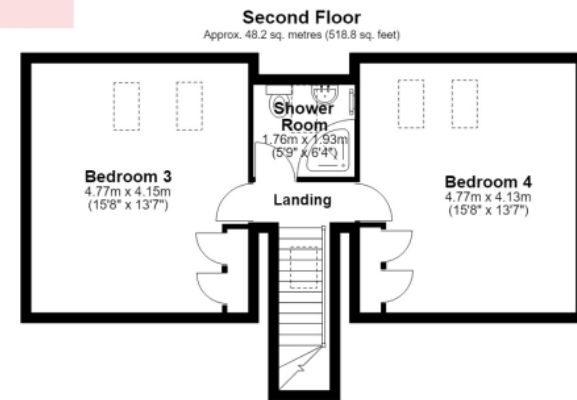
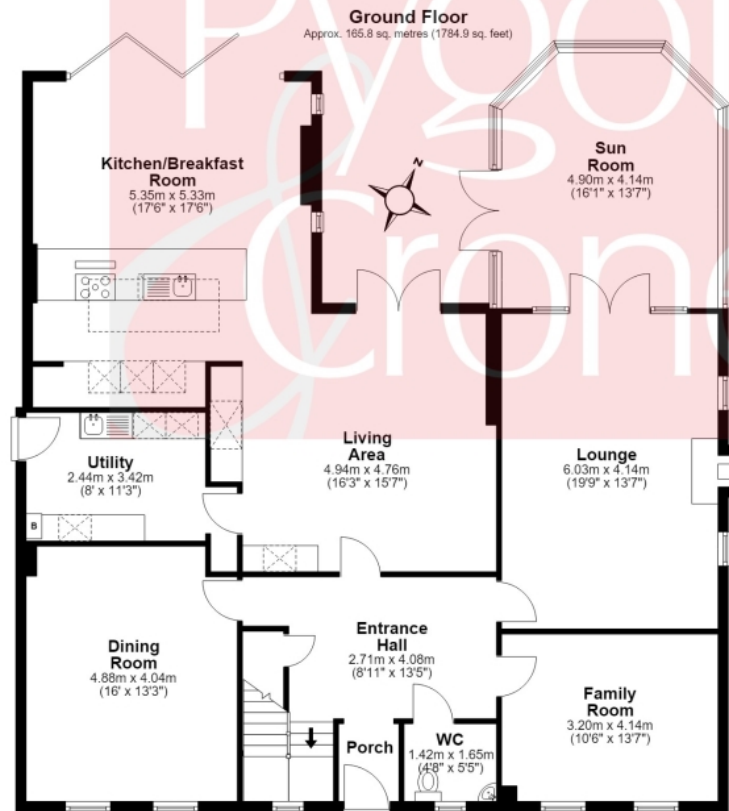

Total area: approx. 358.5 sq. metres (3858.5 sq. feet)

Floor plan created by Matte Black Media.
Plan produced using PlanUp.



Location



Show on Google: [schools](#), [doctors](#), [supermarkets](#), [restaurants](#), [railway stations](#)



Stonebow
Financial Services Ltd

Do you need Financial Help or Advice?

We are offering free advice through Mortgage Advice Bureau. If you would like to discuss your finances or mortgage, we'll arrange for a qualified adviser to call you back at a convenient time.



Bianca van Tonder
Mortgage & Protection Adviser

0330 912 0007

Your home may be repossessed if you do not keep up repayments on your mortgage.

There may be a fee for mortgage advice. The actual amount you pay will depend upon your circumstances. The fee is up to 1% but a typical fee is 0.3% of the amount borrowed.















Houses. Homes. Harmony.

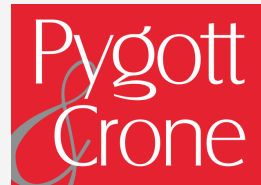

421a, Newark Road, North Hykeham
is on the market with our Lincoln branch

36a Silver Street, Lincoln LN2 1EW

01522 568822