



7 Vacherie Lane
North Kyme, Lincoln, Lincolnshire, LN4 4DL

£310,000

3 Bedroom Detached Bungalow

- Freehold
- Deceptively spacious three double bedroom detached bungalow
- Refitted kitchen with disabled-friendly height units
- Impressive 23ft dining kitchen ideal for modern living
- Lounge with bay window and feature fireplace
- Principal bedroom with en suite and walk-in wardrobe
- Extensive hard landscaped rear garden with large terrace area
- Generous plot backing onto open fields
- Integral double garage with electric door and ample driveway parking
- EPC rating - D, Council Tax Band - C

[Click here to access the Energy Performance Certificate for 7 Vacherie Lane, North Kyme, Lincoln, Lincolnshire, LN4 4DL](#)



Overview

This deceptively spacious and individual detached bungalow is situated down a quiet lane within the rural village of North Kyme and enjoys generous rear gardens backing onto open fields. Offered for sale with no onward chain, the property presents an excellent opportunity for a range of buyers and has been further enhanced by the current owners.

Since purchase, the property has benefited from the installation of a refitted kitchen with disabled-friendly height units, providing both practicality and modern styling. In addition, the rear garden has been significantly improved with extensive hard landscaping, creating a large terrace area ideal for outdoor dining and entertaining.

The well-proportioned accommodation includes a welcoming lounge with bay window and fireplace, a spacious 23ft dining kitchen, utility room, and three double bedrooms. The principal bedroom benefits from an en suite shower room and walk-in wardrobe, complemented by a family bathroom.

Externally, the property stands on a generous plot with ample block paved driveway parking leading to an integral double garage with electric door. The standout rear garden enjoys a high degree of privacy and open views, combining lawned areas with the newly created terrace, making it ideal for both relaxation and entertaining.





Vacherie Lane, North Kyme, Lincoln, LN4



Approximate Area = 1143 sq ft / 106.1 sq m
Garage = 294 sq ft / 27.3 sq m
Total = 1437 sq ft / 133.4 sq m

For identification only - Not to scale

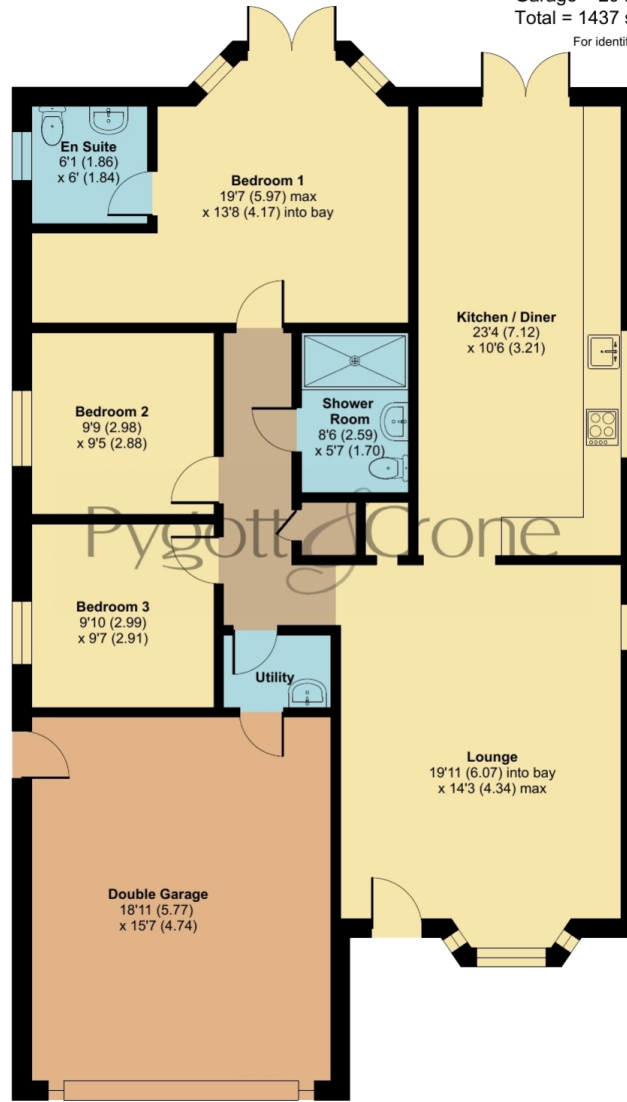

GROUND FLOOR

Floor plan produced in accordance with RICS Property Measurement 2nd Edition, Incorporating International Property Measurement Standards (IPMS2 Residential). © nchecom 2026. Produced for Pygott & Crone. REF: 1431714



Location

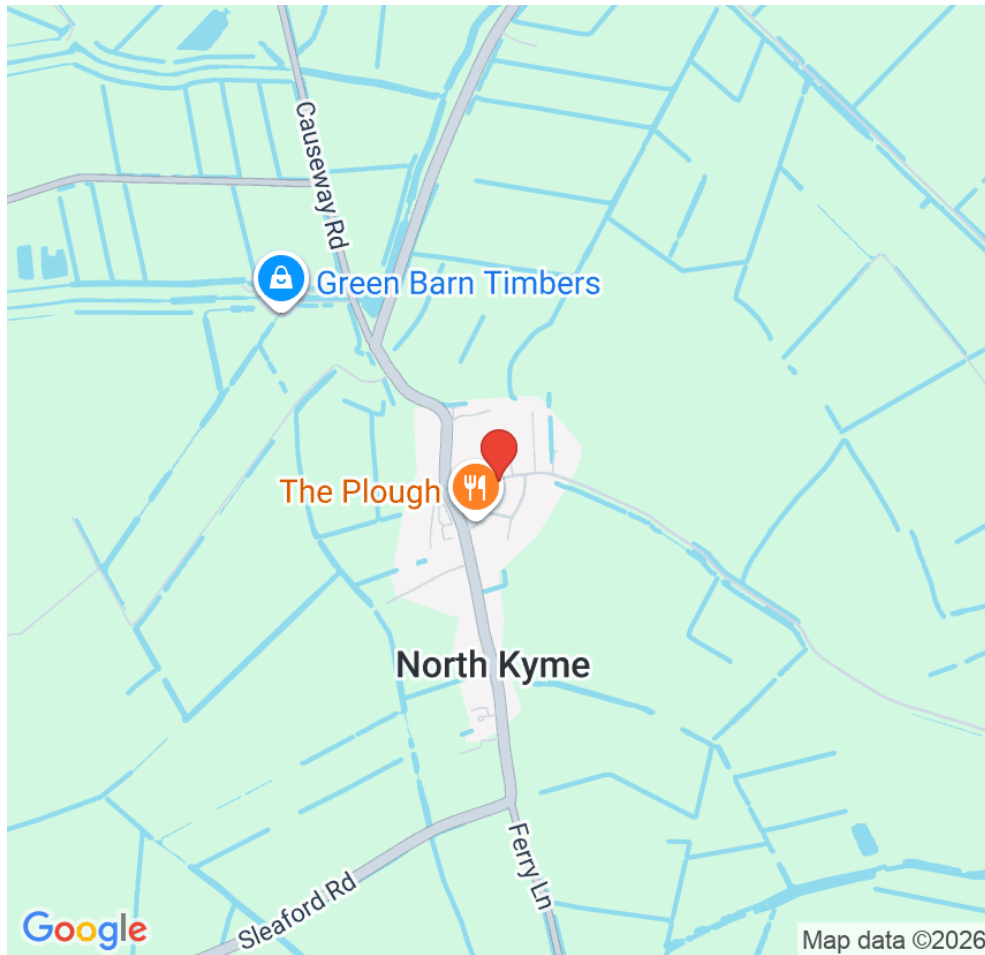

Show on Google: [schools](#), [doctors](#), [supermarkets](#), [restaurants](#), [railway stations](#)



Stonebow
Financial Services Ltd

Do you need Financial Help or Advice?

We are offering free advice through Mortgage Advice Bureau. If you would like to discuss your finances or mortgage, we'll arrange for a qualified adviser to call you back at a convenient time.



Ahmed Jilil
Financial Services Director

0330 912 0007

Your home may be repossessed if you do not keep up repayments on your mortgage.

There may be a fee for mortgage advice. The actual amount you pay will depend upon your circumstances. The fee is up to 1% but a typical fee is 0.3% of the amount borrowed.







Houses. Homes. Harmony.



7 Vacherie Lane, North Kyme
is on the market with our Sleaford branch

19 Southgate, Sleaford NG34 7SU

01529 414333