



41 Gardenia Grove  
Nottingham, Nottinghamshire, NG3 6HY

Offers in excess of  
£335,000

## 3 Bedroom Detached Bungalow

- Freehold
- Stylish 3 bedroom detached bungalow
- Bright open-plan kitchen/living area with skylights and bi-fold doors.
- Modern fitted kitchen
- Decked balcony overlooking a private rear garden.
- Main bedroom plus two additional versatile rooms.
- Contemporary family bathroom.
- Off-street driveway parking.
- Recently upgraded décor
- Peaceful residential setting with excellent access to walking routes and green spaces.
- EPC Rating - C, Council Tax Band - C

[Click here to access the Energy Performance Certificate for 41 Gardenia Grove, Nottingham, Nottinghamshire, NG3 6HY](#)



## Overview

Located in a quiet and highly sought-after Mapperley position, this beautifully presented three bedroom detached bungalow offers stylish, low-maintenance living with an impressive blend of modern design and comfort. The property boasts a smart, freshly rendered exterior that gives the home a clean, contemporary finish and strong curb appeal from the moment you arrive. Inside, the heart of the home is the bright open-plan kitchen, dining and living area, enhanced by skylights and bi-fold doors that open directly onto a raised decked balcony. This creates a seamless indoor-outdoor flow, perfect for relaxing, entertaining, or simply enjoying the peaceful outlook over the private rear garden.



The contemporary kitchen features quality cabinetry, generous worktop space and integrated appliances, making it both practical and attractive for everyday living. All three bedrooms are well proportioned, offering flexibility for family life, guests, or a dedicated home office. A modern family bathroom, finished with sleek tiling and stylish fittings, completes the internal accommodation.

Outside, the property benefits from off-street parking on a private driveway, while the rear garden provides a secure and tranquil area for outdoor enjoyment. The décor throughout has been recently refreshed, giving the bungalow a clean, move-in-ready feel. Set within easy reach of Mapperley's popular shops, cafés, schools, and transport links. As well as nearby walking routes and green spaces, this is a superb opportunity to acquire a beautifully finished home in a prime residential location.





# Gardenia Grove, Nottingham, NG3

Approximate Area = 1005 sq ft / 93.4 sq m

For identification only - Not to scale

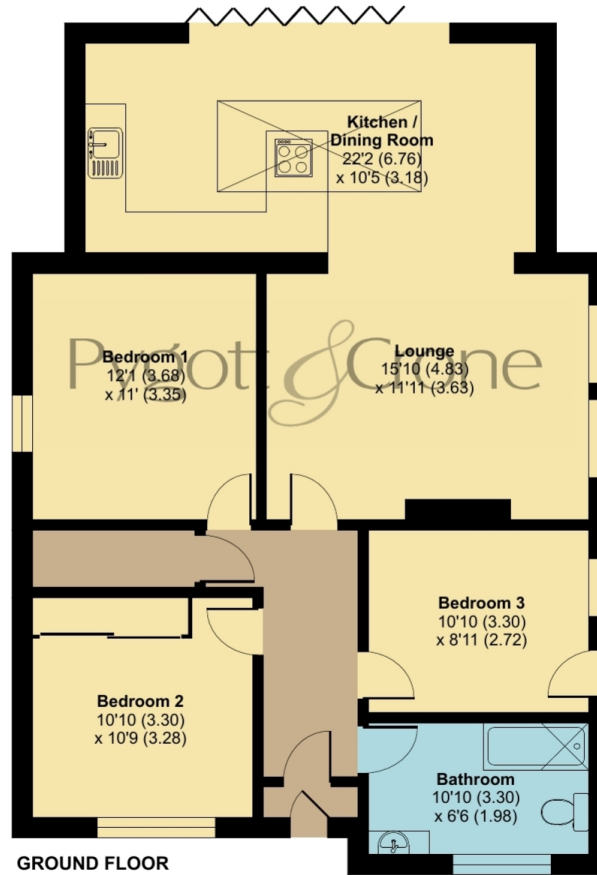

Floor plan produced in accordance with RICS Property Measurement 2nd Edition, Incorporating International Property Measurement Standards (IPMS2 Residential). © ncthemcom 2025. Produced for Pygott & Crone. REF: 1388232



## Location



Show on Google: [schools](#), [doctors](#), [supermarkets](#), [restaurants](#), [railway stations](#)



**Stonebow**  
Financial Services Ltd

### Do you need Financial Help or Advice?

We are offering free advice through Mortgage Advice Bureau. If you would like to discuss your finances or mortgage, we'll arrange for a qualified adviser to call you back at a convenient time.



Jay Zhou

Trainee Mortgage & Protection Adviser

0330 912 0007

Your home may be repossessed if you do not keep up repayments on your mortgage.

There may be a fee for mortgage advice. The actual amount you pay will depend upon your circumstances. The fee is up to 1% but a typical fee is 0.3% of the amount borrowed.









Houses. Homes. Harmony.



**41 Gardenia Grove, Nottingham**  
is on the market with our Nottingham branch

---

43 Bridlesmith Gate, Nottingham NG1 2GN

0115 896 5072