



13 Bishops Court  
Sleaford, Lincolnshire, NG34 7BQ

£75,000

## 2 Bedroom Ground Floor Flat

- Leasehold
- For Sale With No Onward Chain
- Over 55's 2 Bedroom Ground Floor Apartment
- Leasehold Property having 62 years remaining
- Lounge Having 2 bay windows.
- Kitchen with Pantry Off, Bathroom
- Communal Parking to the front
- Good location for access to Sleaford
- Viewing Highly Recommended
- EPC Rating - C, Council Tax Band - A

[Click here to access the Energy Performance Certificate for 13 Bishops Court, Sleaford, Lincolnshire, NG34 7BQ](#)



## Overview

Pygott and Crone are pleased to offer for sale this Over 55's spacious two-bedroom ground floor apartment, available with no onward chain. Ideally located for convenient access to Sleaford town centre, this property presents a fantastic opportunity for first-time buyers, investors, or those looking to downsize.

The accommodation briefly comprises a welcoming entrance hall, a light and airy dual-aspect lounge featuring charming bay windows, a fitted kitchen complete with a separate pantry, two well-proportioned bedrooms, and a family bathroom.

Externally, the property benefits from communal parking situated to the front. Viewing is highly recommended to fully appreciate both the generous size and desirable location of this apartment.

Please note - We have been advised that the property is Leasehold with 62 years left on the lease and that the cost per annum for ground rent and service charge can be obtained from the agents office but we are advised it is a peppercorn rent.





# Bishops Court, NG34

Approximate Area = 636 sq ft / 59 sq m

For identification only - Not to scale

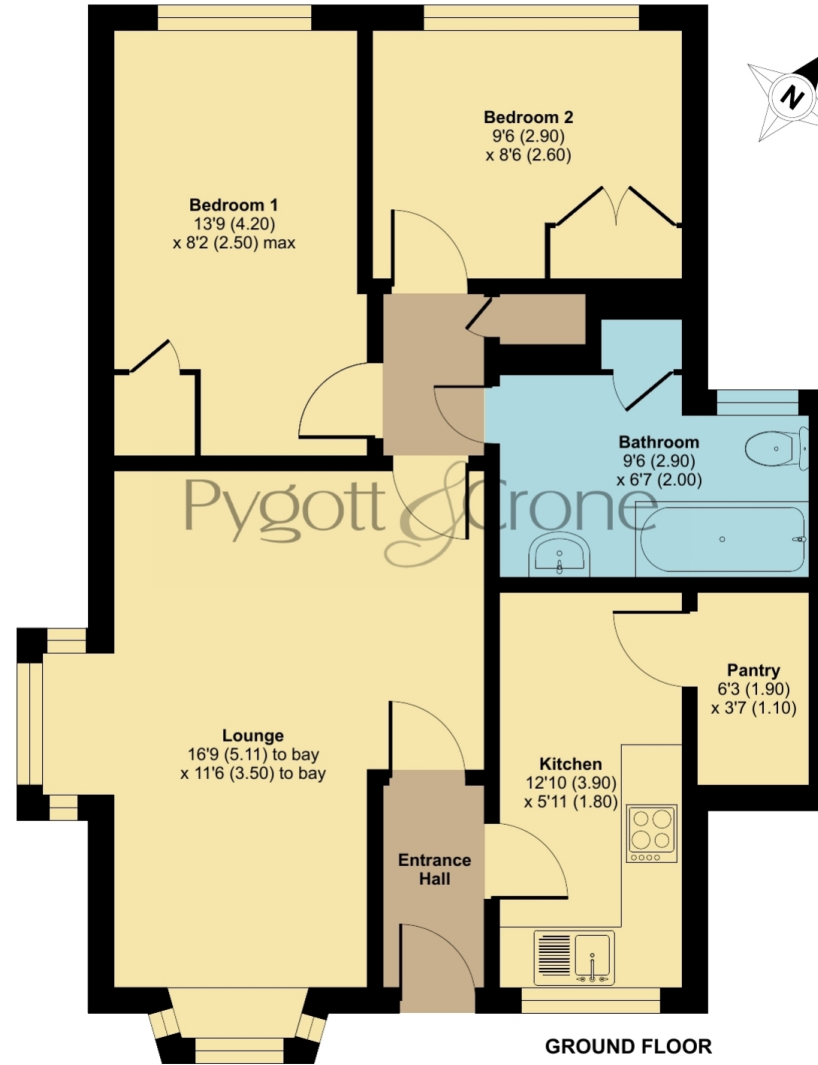

Floor plan produced in accordance with RICS Property Measurement 2nd Edition, Incorporating International Property Measurement Standards (IPMS2 Residential). © nrichcom 2025. Produced for Pygott & Crone. REF: 1273124



## Location



Show on Google: [schools](#), [doctors](#), [supermarkets](#), [restaurants](#), [railway stations](#)



**Stonebow**  
Financial Services Ltd

### Do you need Financial Help or Advice?

We are offering free advice through Mortgage Advice Bureau. If you would like to discuss your finances or mortgage, we'll arrange for a qualified adviser to call you back at a convenient time.

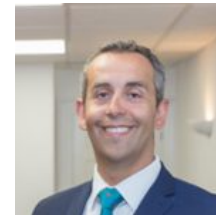

Ahmed Jilil  
Financial Services Director

0330 912 0007

Your home may be repossessed if you do not keep up repayments on your mortgage.

There may be a fee for mortgage advice. The actual amount you pay will depend upon your circumstances. The fee is up to 1% but a typical fee is 0.3% of the amount borrowed.

Houses. Homes. Harmony.



**13 Bishops Court, Sleaford**  
is on the market with our Sleaford branch

---

19 Southgate, Sleaford NG34 7SU

01529 414333